

## 12. Changing routine maintenance parts

Sealing parts are composed of the following routine maintenance parts. If they are damaged, proper replacement is important.

### Warning

When replacing parts, follow the instructions carefully.

### Warning

Always unplug power cord before replacing parts.

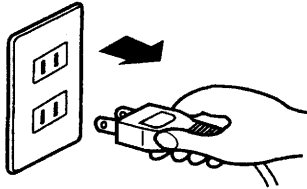

[1]V-300 components of sealing area

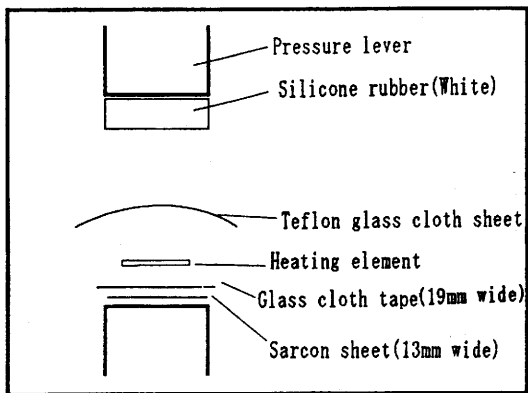

[2]V-300-10D Components of sealing area

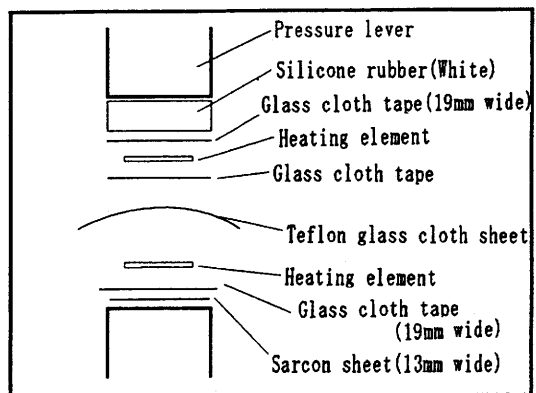

### (1) Replacing heating element

The terminal section consists of the parts shown at left.

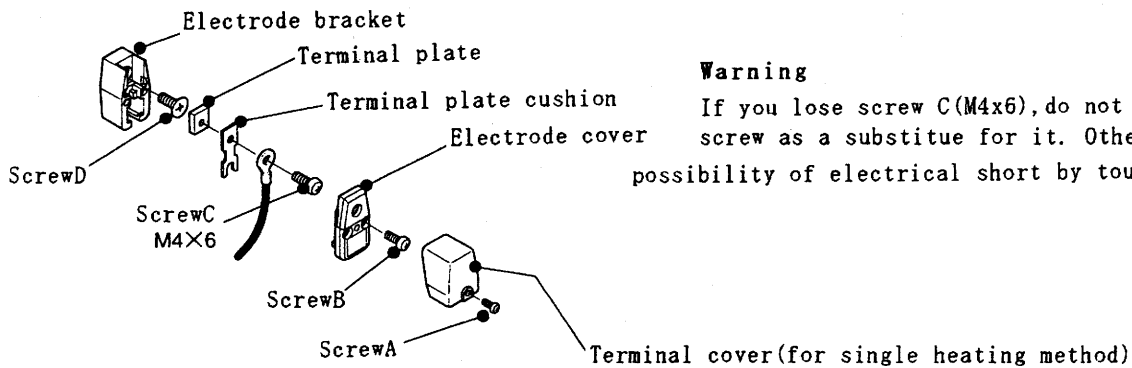

### Warning

If you lose screw C (M4x6), do not use longer screw as a substitute for it. Otherwise, there is a possibility of electrical short by touching the screw D.

## LOWER SECTION

Heating elements are either sold by themselves  
(20pcs/set) or as a part of the spare parts replacement kit.

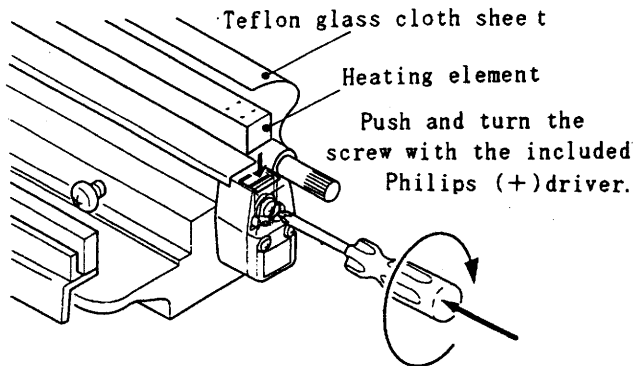

1. Remove the lower teflon glass sheet  
(See indexing glass cloth sheet section for reference)
2. Remove the glass tape which is on the upper side of heating element.
3. Loosen the terminal cover mounting screw and remove the terminal cover. (As shown at left) Then, loosen the screw in the hole on the electrode cover and remove heating element. (No need to remove electrode cover)

## UPPER SECTION

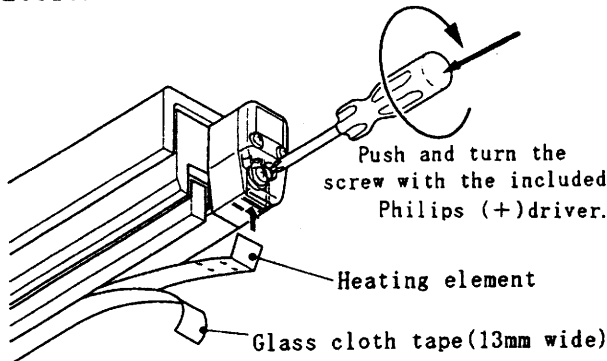

4. When mounting, fasten the heating element mounting screws while holding the heating element down with your finger to make sure that it doesn't slip from position.
5. On the upper section, place the glass tape so that it slightly overlaps both sides of the electrode bracket. Instructions on the replacement of the teflon sheet for the lower section are detailed below.

## (2) Indexing teflon glass cloth sheet

Heating element are sold either by themselves  
or as a part of the spare parts replacement kit.

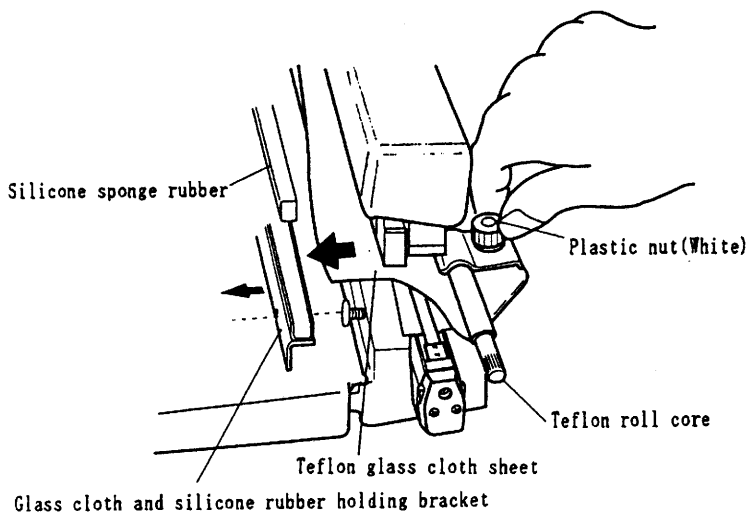

1. Remove glass cloth holding bar screws.
2. Loosen plastic nuts enough so that the glass cloth sheet can be pulled forward in the direction of the arrow. Pull until a new surface appears.
3. Cut away excess with scissors. Tighten plastic nuts and reassemble.

### (3) Replacement of self adhesive sarcon sheet and self adhesive glass cloth tape.

Heating element are sold either by themselves or as a part of the spare parts replacement kit.

1. Remove whole sarcon sheet and glass cloth tape. Residue can be cleaned away with isopropyl alcohol.
2. Put new sarcon sheet on the surface in accordance with the seal element length.
3. Put new glass cloth self adhesive tape on top of the Sarcon sheet, beging from the point approximately 5mm(0.2inch) from the edge.

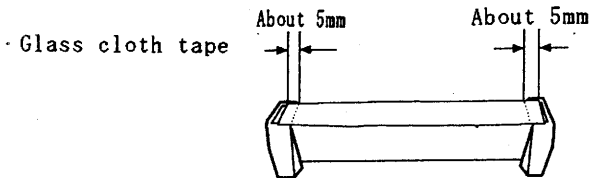
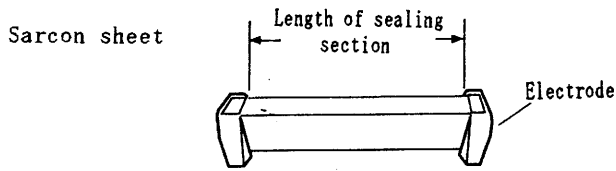

**MEMO** (If new tape is placed over old adhesive, sealing area may become uneven and allow for air pockets that will cause early deterioration of the element and glass cloth.)

### (4) Cleaning filter and replacement of filter cartridge

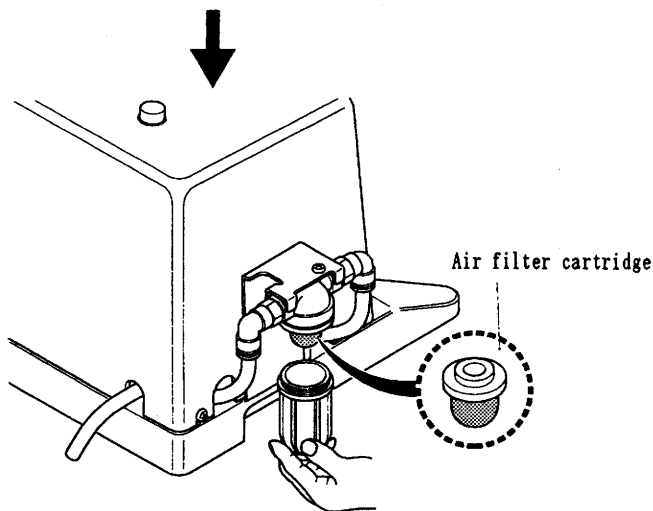
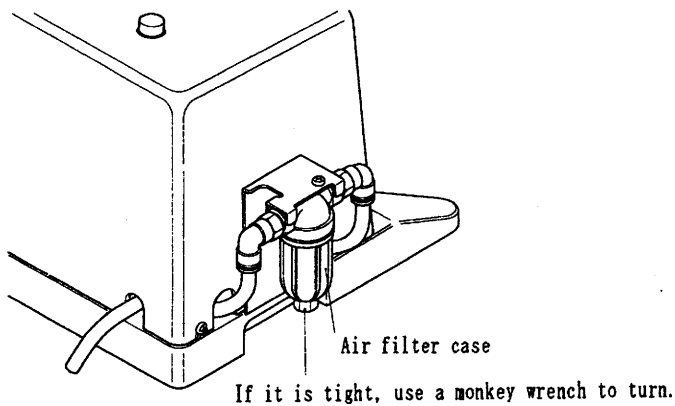

1. If the filter is blocked with foreign materials, unscrew the plastic holder, remove and clean it.

2. If the filter cartridge is clogged, vacuum will be affected. Remove filter cartridge and replace with spare cartridge provided.

3. To replace cartridge, remove the filter cartridge case by turning counter-clockwise.

Remove the clogged filter cartridge and replace with a new cartridge before reassembling filter.

### (5) Replacing the nozzle

In case of severe blockage, remove and clean the nozzle as show below.

1

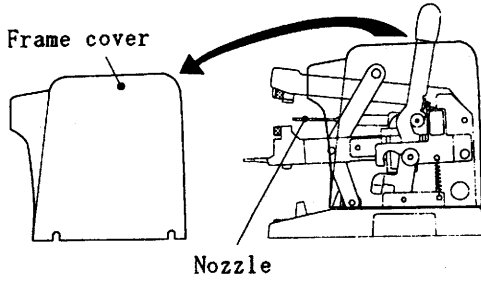

1. Remove the frame cover and table.

2

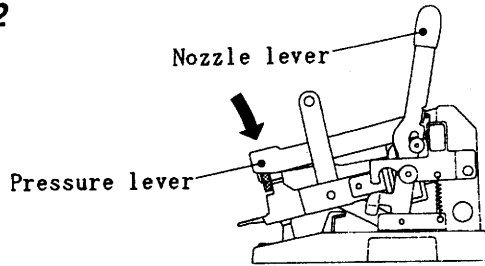

2. Press down the floating pressure bar as far as it will go. Leave the nozzle lever in an upright position.

3

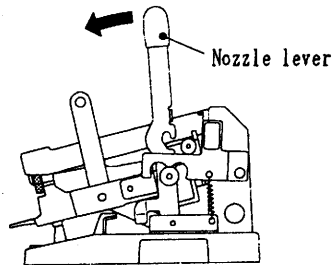

3. Now, with the pressure bar in the down position, pull the nozzle lever forward to release it from its coupling.

4

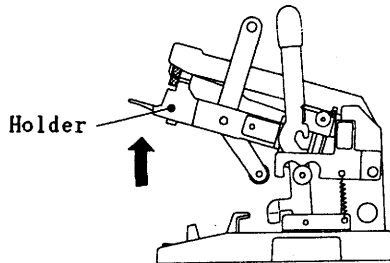

4. Raise up the holder while still holding onto the nozzle lever.

5

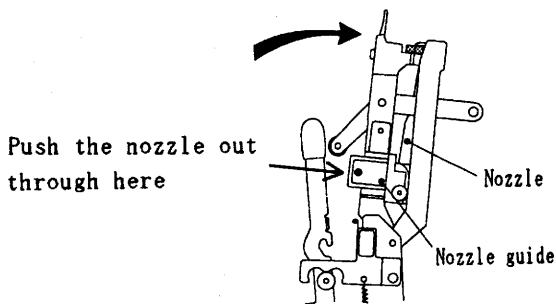

5. Raising the holder section even more will permit you to see the nozzle guide that is under the nozzle itself.

6

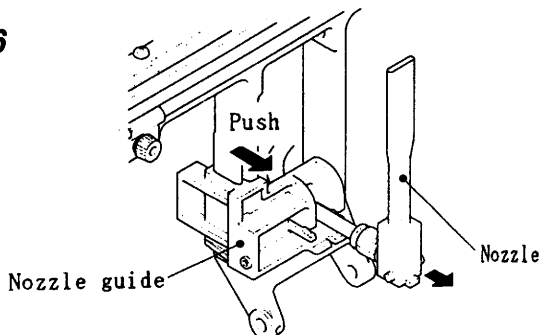

6. The nozzle is simply fit inside the nozzle guide, so it can be removed with just a push of your finger. Upon replcement, insert the nozzle firmly until it clicks.

### 13. Adjusting sealing pressure

The proper sealing pressure is different depending on the type of film used.  
Adjust sealing pressure for proper sealing.

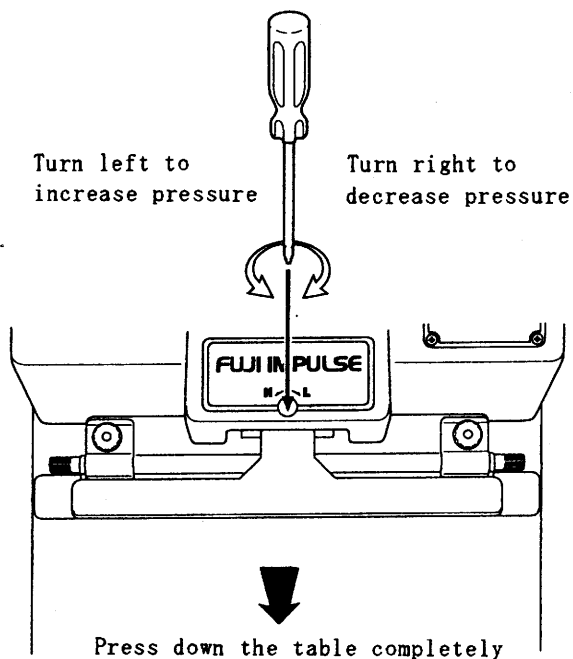

#### Warnig

It is very dangerous to adjust the sealing pressure with the power ON, as the microswitch may inadvertently be activated. Please unplug the power cord before performing this operation.

1. Press down the table so that the pressure adjusting screw can be seen from the adjusting hole on the frame cover.
2. Adjust sealing pressure by turning the adjusting screw with the philips driver.
3. Turn the screw left to increase the sealing pressure. Turn toward (H).
4. Turn the screw right to decrease the sealing pressure. Turn toward (L).

#### Caution

Excessively tightening or loosening the adjustment screw may damage certain parts or cause them to come apart.

Please use caution when adjusting the screw.